

# HON

**MIRUS<sup>®</sup>**  
Seating



CHAIRS THAT BRING OUT  
THE BEST IN PEOPLE

# Productivity Realized

In today's workplace, expectations are high. Day in and day out, businesses expect their people to do more, and to do it better. The single most helpful tool employers can provide—the one that can have the greatest positive impact on the productivity and everyday well-being of workers—is a great work chair.

Enter Mirus. Designed for The HON Company by award-winning industrial designer Wolfgang Deisig, Mirus delivers the support and comfort that professionals at all levels of an organization need to be productive.





C



B

## MAKE IT YOUR CHAIR

Mirus makes it easy for people to get comfortable and stay that way. Intuitive adjustments not only fine-tune a more personalized fit, but they also inspire people to actually use them. Once properly adjusted, the Mirus work chair's innovative synchro-tilt motion supports the body's natural movement as people move between upright and reclined postures.

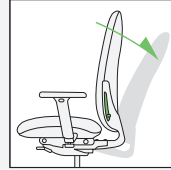

### SYNCHRO-TILT

Back reclines 2.5 degrees for every degree the seat reclines to better support the natural motion of the body as you recline. Synchronized support means greater comfort throughout the workday.

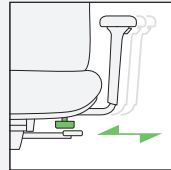

### ARM WIDTH

Accommodates people of various sizes by moving arms in or out from the seat.

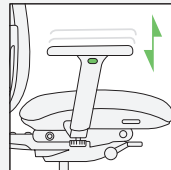

### ARM HEIGHT

Arms move up or down to support your forearms comfortably and lessen stress on your shoulders.

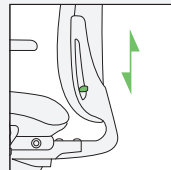

### LUMBAR SUPPORT

Offers a full 4 inches of adjustable lumbar support to fit the curve of your spine for healthful long-term sitting.

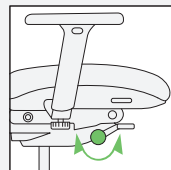

### TENSION KNOB

Adjusts the support felt when you lean back, covering the full range of support in just 4 complete turns of the conveniently located knob.

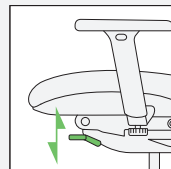

### TILT LOCK

Fixes the tilt in one of four positions—one forward, three reclining—to support different tasks.

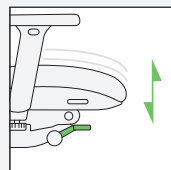

### SEAT HEIGHT

Allows you to adjust the seat to a height where your feet can be flat on the floor and your upper legs properly supported.

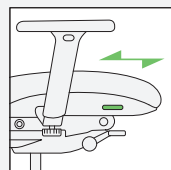

### SEAT DEPTH

Controls the depth of the seat so your upper legs are properly supported and leg circulation is unimpeded.

## STYLE POINTS

Mirus proves that a stylish chair doesn't need to be an expensive chair. With their light scale and fully upholstered backs, Mirus work chairs, guest chairs, and task stools bring a contemporary sophistication to the office.



**WORK CHAIR  
MID-BACK**



**WORK CHAIR  
LOW-BACK**



**TASK STOOL  
LOW-BACK**



**GUEST CHAIR  
ARMLESS, WITH GLIDES**



**GUEST CHAIR  
WITH ARMS AND CASTERS**



### WELCOME OPTIONS

Whatever options you need—casters or glides, with arms or armless—Mirus guest chairs coordinate beautifully with Mirus work chairs. They're there when you need them, and they stack up to four-high for convenient storage when you don't.

### PRODUCTS, MATERIALS, AND FINISHES SHOWN:

**Front A:** Mirus low-back work chair in Attire Taupe.

**Inside Spread B:** Mirus mid-back work chairs in Arrondi Berry. Initiate™ workstations with fabric panels in Twilight Ethereal, finish in Platinum Metallic, with laminate worksurfaces in Steel Mesh. Flagship™ storage in Platinum Metallic.

**Inside Spread C:** Mirus low-back work chairs in Bridge Flaxen. Arrive™ conference room in Shaker Cherry with Empire handles in Matte Chrome.



the BIFMA sustainability standard



SCIENTIFIC CERTIFICATION SYSTEMS  
SCS-IND-01780

**HON**®

The HON Company  
200 Oak Street  
Muscatine, IA 52761  
800.833.3964  
hon.com

© 2010 The HON Company. Form No. H3847 (12/10)  
HON, Flagship, Initiate, and Mirus are registered trademarks of HNI Technologies, under license to The HON Company. Arrive is a trademark of The HON Company. level is a trademark of BIFMA International. Indoor Advantage is a trademark of Scientific Certification Systems. Models, upholstery, and finishes are subject to change without notice.